

CRL ALUMINUM DOOR MOUNTED STANDARD PULL HANDLES

CRL BACK-TO-BACK GLASS MOUNTED STRAIGHT PULL HANDLE

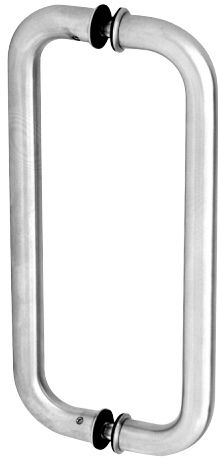

CAT. NO.
 CM10X10
 CM12X12
 CM18X18
 CM24X24

INCLUDED MOUNTING HARDWARE

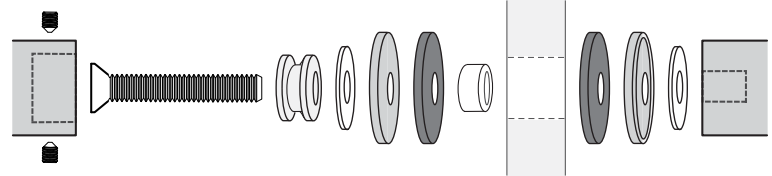

5/16"-18 Back-to-Back
 Glass Door Mount Shown

MOUNTING TEMPLATE

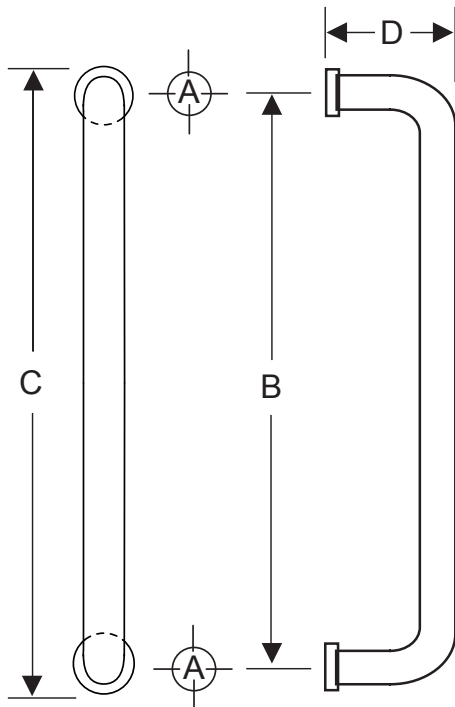

ADD TO CAT. NO. FOR FINISH

BR = POLISHED BRASS

BS = BRUSHED STAINLESS

PS = POLISHED STAINLESS

SA = SATIN ANODIZED

DU = DARK BRONZE

CAT. NO.	B	C	D
CM10X10	10" (254 mm)	11" (279 mm)	2-7/8" (73 mm)
CM12X12	12" (305 mm)	13" (330 mm)	2-7/8" (73 mm)
CM18X18	18" (457 mm)	19" (483 mm)	2-7/8" (73 mm)
CM24X24	24" (610 mm)	25" (635 mm)	2-7/8" (73 mm)

Mounting Options	Glass 3/8"-3/4" (10 to 19 mm)	Wood/Aluminum up to 1-3/4" (45 mm)
Hole Size: A	5/8" (16 mm)	5/16" (8 mm)
Hardware	Cat. No. F40WK Included	Cat. No. TB4CH Optional

NOTE: Optional hardware kits must be purchased separately.

