



## RUBBER WEATHERSTRIPS – TWO-PIECE SELF-SEALING WEATHERSTRIP

### INSTALLATION INSTRUCTIONS

Two-Piece Self-Sealing Weatherstrips - Catalog Numbers:

**AS1035, AS1179, AS1216, AS1456, AS1475, AS1488, AS1656, AS1706, AS1707, AS1708**

**1A** – Follow step 1X (One-Piece Self-Sealing Weatherstrip Instructions). Strip is withdrawn slightly at starting point in such a way that it matches the overlap. Ends of strip are brought together and are then forced over the body panel. This is necessary to ensure a tight, smooth joint. Follow steps 2X and 3X (One-Piece Self-Sealing Weatherstrip Instructions - lubricating strip and inserting glass).

**2A** – Working in both directions from starting point, lift glass channel lip allowing glass to easily slip into position. At final corner use the locking tool to open the glass channel to insert remaining glass edge.

**3A** – Filler strip is inserted into eye of specially designed filler strip installation tool. Eye is constructed so that it will prevent filler strip from twisting.

**4A** – At top, away from strip joint, filler strip and eye of tool are inserted into strip's channel. During first motion of tool, end of filler strip is held in position with thumb.

**5A** – Move tool along channel with zipper-like motion. Filler strip feeds through eye and threads into channel. Rounding corners is easiest when tool is “wiggled” slightly.

**6A** – When starting point is reached, the tool is removed. Filler strip should be cut to overlap starting point by approximately 1/4" so that when both ends are forced into place, joint will be under pressure for a tight fit.

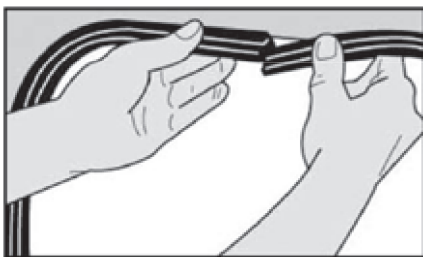

1A

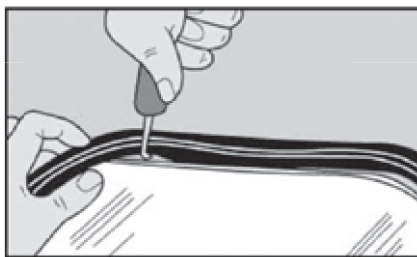

2A

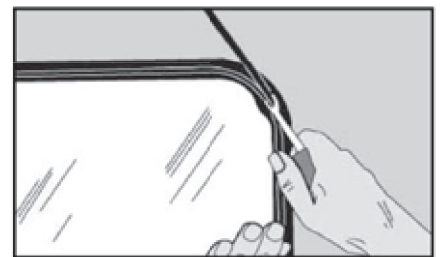

3A

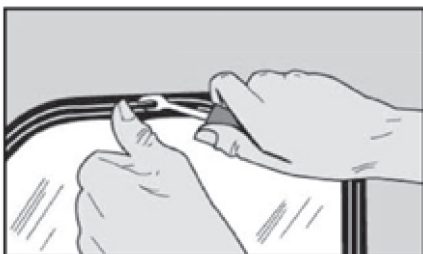

4A

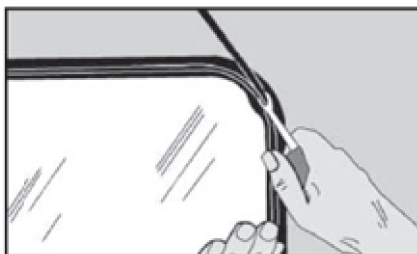

5A

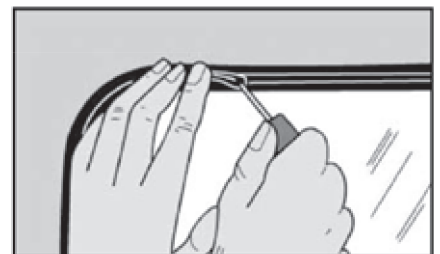

6A