

# Rod Display System

## Installation Guidelines

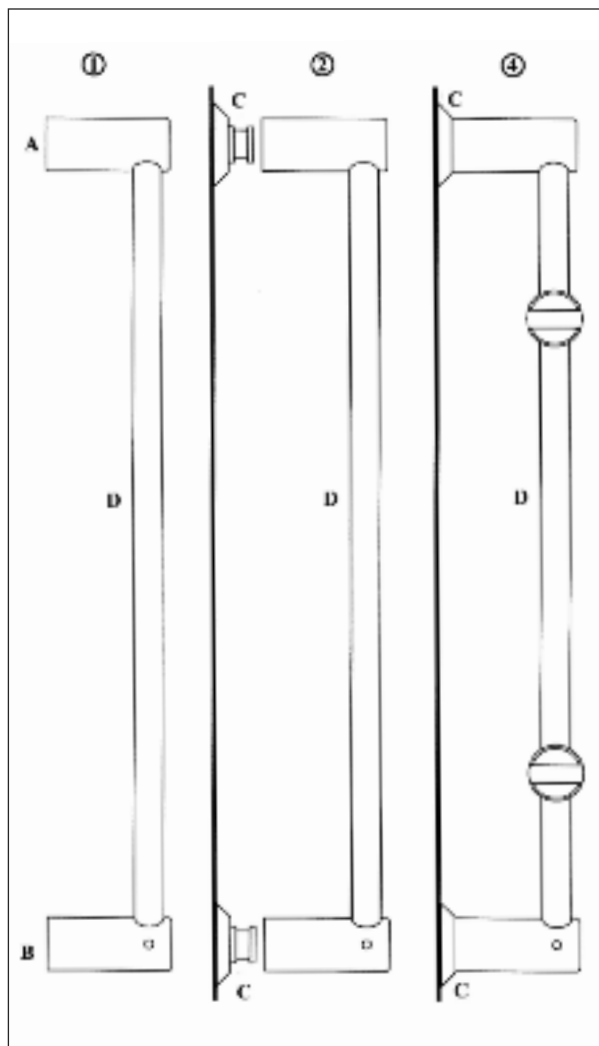

### WALL TO WALL - 10 MM ROD INSTALLATION

**Important:** It is important to check the substrate to ensure the mounting surface will be strong enough to hold the weight of the system and the display. Installation should only be done with proper mounting hardware.

1. Combine/stack the required lengths of Rod to achieve desired length for assembly (ARM1041, ARM621 and ARM1059)

Cut Rod to size before the following step. Cut **ONLY** on the side with round tip or internal threads.

2. After assembling Rods to your required height you may thread the completed Rod into Part A and attach Part B to the bottom with M4 Allen Screw.
3. Using the above now constructed assembly (Parts A and B), as a template, measure and mark positions on wall and install Parts C.  
Use horizontal or vertical level tool to ensure the application is level and/or plumb. Always use proper hardware when installing parts onto the wall's surface.  
-Wood screw for wood.  
-Toggle bolt for drywall, plaster, or cement board.
4. After your installation points have been marked you may remove Part B from the Rod Assembly and slip on any Panel Connectors you have for your application. After any additional panel connectors have been placed you can reinstall Part B and re-tighten the M4 Allen Screw.
5. With your fully assembled Rod you may place over Parts C and tighten the M4 Allen Screws at the top and bottom for a permanent fixture.
6. At this point you may tighten all M4 Allen Screws, including those on the Panel Connectors, once they have been placed at your desired location.



(A) ARBASM10



(B) ARBAH10



(C) ACA22624



(D) ARM621  
21" Rod



ARM1041  
41" Rod



ARM1059  
59" Rod

It is important to check that parts are properly tightened prior to usage

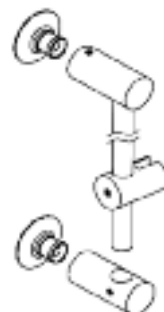

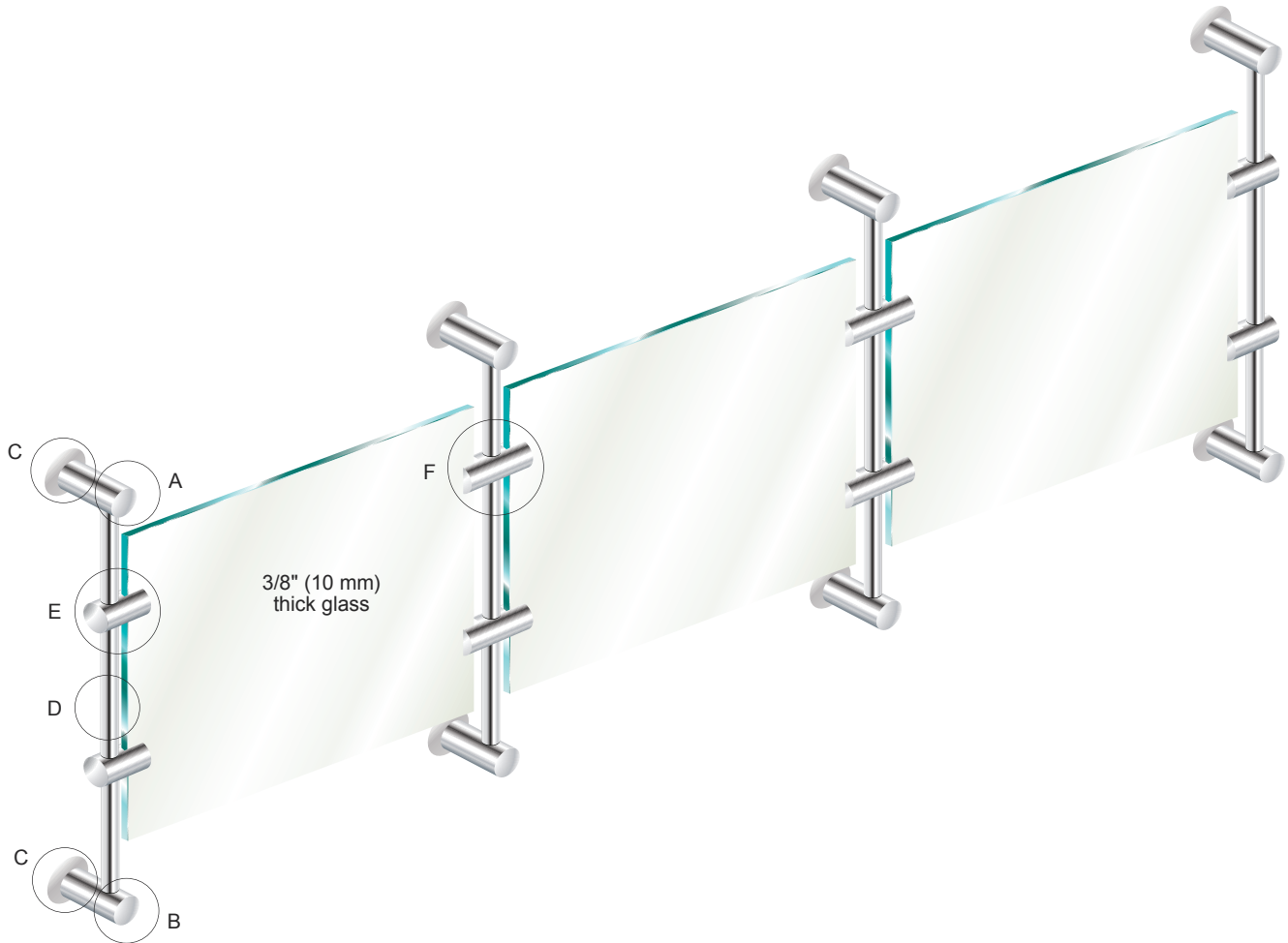

**A** ARBASM10  
Wall Mount  
Cap Top



**B** ARBAH10  
Coupling  
Cap



**C** ACA22624  
Wall  
Mount

**D** Rods



ARM621  
21" Rod



ARM1041  
41" Rod



ARM1059  
59" Rod

**E** One-Way  
Connectors



ARVPC6  
1/4" Connector



ARVPC10  
3/8" Connector

**F** Two-Way  
Connectors



ARDVPC6  
1/4" Connector

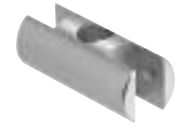

ARDVPC10  
3/8" Connector